

## CONTACT RATING

AC	Inductive load	AC125V	AC250V	AC440V	AC600V	DC	Inductive load	DC125V	DC250V	DC380V
	Resistive load	6A	4A	2A	1A		Resistive load	0.5A	0.2A	0.1A
		10A	6A	4A	1.5A			2A	0.6A	0.2A

## CHARACTERISTICS

Ambient temperature	-20℃ ~ +60℃	
Humidity	45 ~ 85% RH	
Contact resistance	50mΩ max. (initial value)	
Insulation resistance	100mΩ min. (at 500 VDC)	
Dielectric strength	2500VAC, 50/60HZ for 1 minute	
Service life	Mechanically	Push Button/Illuminated Push Button (Momentary) 3,000,000, Others 500,000
	Electrically	500,000 operations

## STANDARD CONTACT BLOCKS

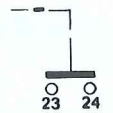
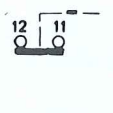
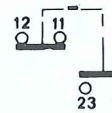
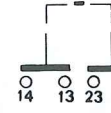
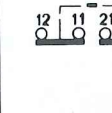
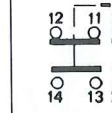
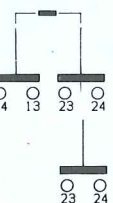
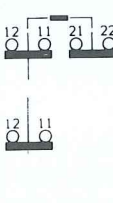
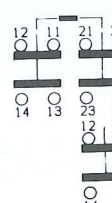
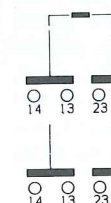
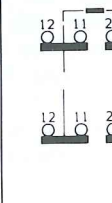
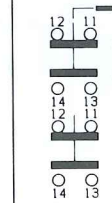
Type	TC-1A	TC-1B	TC-1C	TC-2A	TC-2B	TC-2C
Contact	1a	1b	1a1b	2a	2b	2a2b
Contact Arrangement						
Type	TC-3A	TC-3B	TC-3C	TC-4A	TC-4B	TC-4C
Contact	3a	3b	3a3b	4a	4b	4a4b
Contact Arrangement						

## STANDARD TYPES OF CONTACT BLOCK AND ASSEMBLY METHOD.

Short contact block is available in 1a, 1b, 1a1b, 2a, and 2b. The contact may be increased to 2a2b by replacing the short block with the long one. If more contacts are needed, just add the short one to the long one (The short one is not designed for being added by other block at its rear end). 3a, 3b, 3a3b, 4a, and 4b will be available with one-long-one-short blocks. By replacing the short block with another long one and becoming two-long blocks, 4a4b will be obtainable.

## STANDARD CONTACT BLOCKS DIMENSIONS

TC-1A · TC-1B · TC-1C  
TC-2A · TC-2B

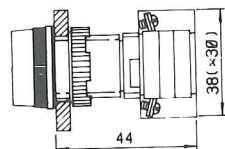

TC-3A · TC-3B · TC-3C  
TC-4A · TC-4B

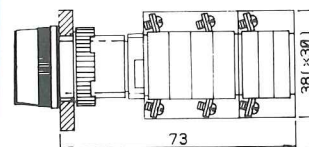
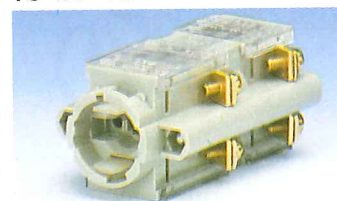

M3x44 SCREW 2PCS.  
M3 NUT 2PCS.

TC-2C

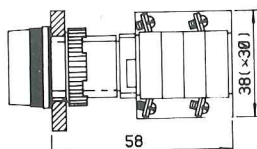
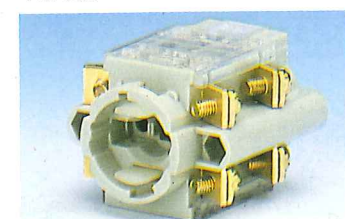

TC-4C

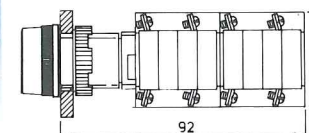
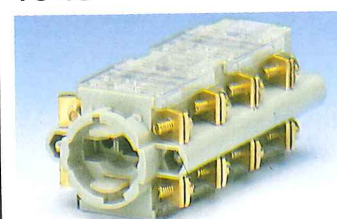

M3x55 SCREW 2PCS.  
M3 NUT 2PCS.



# PUSH BUTTON SWITCH ( $\phi 22/\phi 25/\phi 30$ )

IEC144 IP65

The contact block of this series of switches is standard. See page @ 2 for types, drawing of contacts and assembly dimension.

## MODEL DESIGNATION

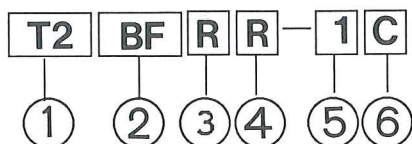

Designation	Signal	Description
1. Mounting Hole	T2 T3	$\phi 22\text{mm}/\phi 25\text{mm}$ $\phi 30\text{mm}$
2. Type	BF BL BM BA BB BK BT PB	Flat Head Long Head Mushroom Head Long Head (Alternate) Mushroom Head (Alternate) Push-Lock Twin-Touch Simple

Designation	Signal	Description
3. Shape	R S L	Round Square Rectangular
4. Lens Color	R G Y W B BL	Red Green Yellow White Black Blue
5. No. of Contact Blocks Fitted	1-4	1-4
6. Type of Contact Blocks fitted	A B C	1a 1b 1a1b

1. The upper base and contact block in simple type are of one unit, available with 1a1b contact,  $\phi 22\text{mm}/\phi 25\text{mm}$  fixing hole, round type only.
2. The mounting holes of square series are  $\phi 22\text{mm}/\phi 25\text{mm}$  available.
3. Twin-Touch Push Button is available with rectangular shape.

## OPERATING HEADS DIMENSIONS

T2BFR

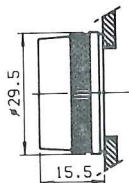

T3BFR

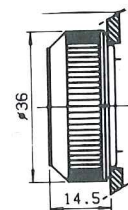

T2BLR

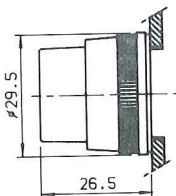

T3BLR

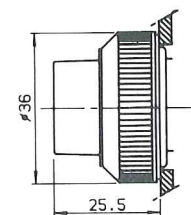

T2BMR

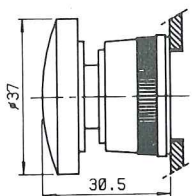
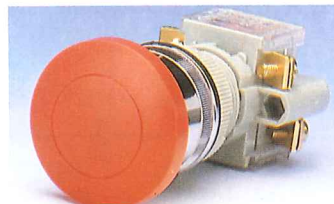

T3BMR

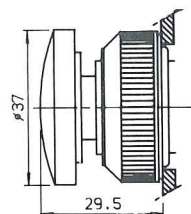

T2BAR

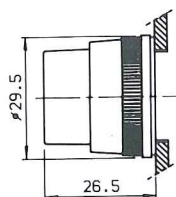

T3BAR

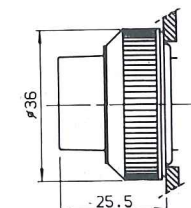





# PUSH BUTTON SWITCH ( $\phi 22/\phi 25/\phi 30$ )

IEC144 IP65

T2BBR

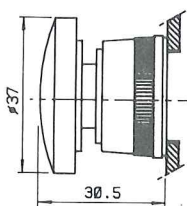
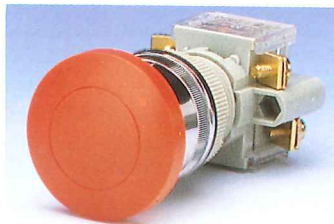

T3BBR

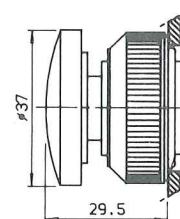

T2BKR

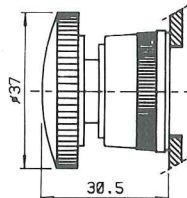

T3BKR

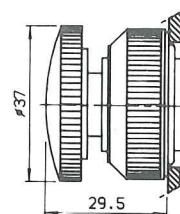

T2BTL

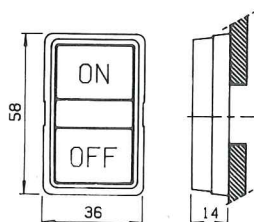

T3BTL

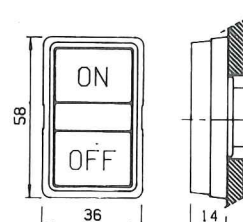
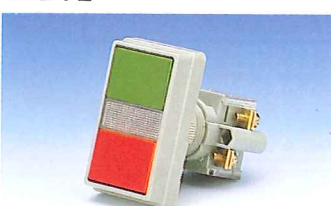

T2BFS

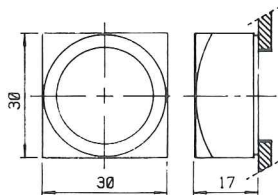
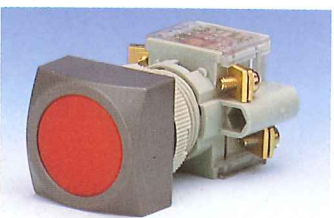

T2BLS

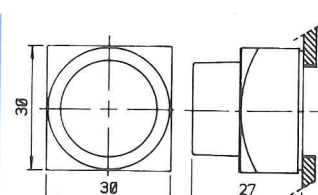

T2BMS

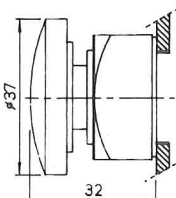
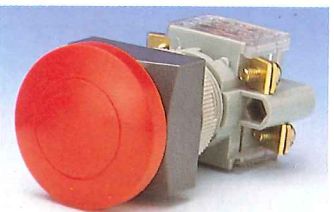

T2BAS

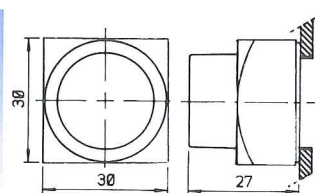

T2BBS

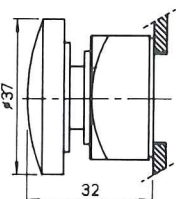
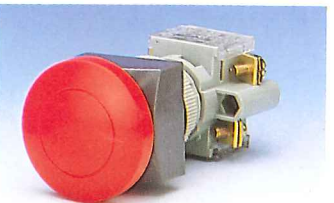

T2BKS

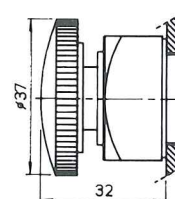

T2PB

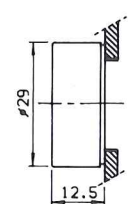







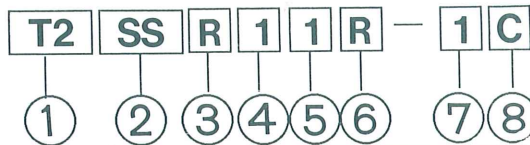

# SELECTOR SWITCH ( $\phi 22/\phi 25/\phi 30$ )



IEC144 IP65

The contact block of this series of switches is standard. See page B2 for assembly dimension.

## MODEL DESIGNATIONS



Designation	Signal	Description
1. Mounting Hole	T2 T3	$\phi 22\text{mm}/\phi 25\text{mm}$ $\phi 30\text{mm}$
2. Type	SS SH KS	Knob Operator Lever Operator Key Operator
3. Shape	R S	Round Square
4. Positions	1	 45° 2-Position
	2	 90° 2-Position
	3	 45° 2-Position Spring return from right
	4	 45° x2 3-Position
	5	 45° x2 3-Position Spring return from right
	6	 45° x2 3-Position Spring return from left
	7	 245° x2 3-Position 2-Way spring return

Designation	Signal		Description
5. Key Withdrawable	1		0.1 Key withdrawable
	2		0 Key withdrawable
	3		1 Key withdrawable
	4		0.1.2 Key withdrawable
	5		0 Key withdrawable
6. Lens Color	R G B		Red Green Black
7. No. of Contacts Fitted	1-4		1-4
8. Type of Contact Blocks Fitted	A B C	2-Position	3-Position
		1a	—
		1b	—
		1a1b	1a 0 1a

## OPERATING HEADS DIMENSIONS

T2SSR

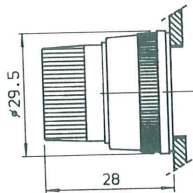

T3SSR

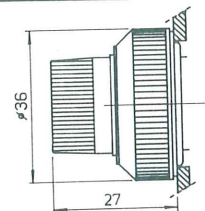

T2SHR

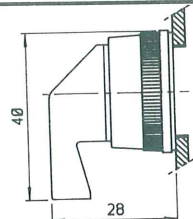

T3SHR

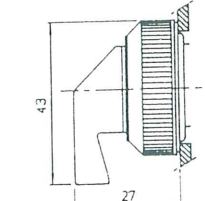

T2KSR

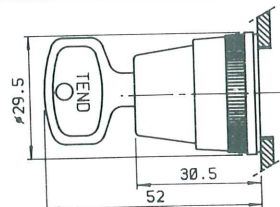

T3KSR

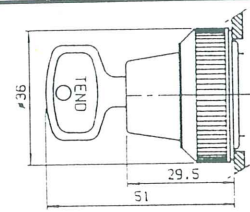

T2SSS

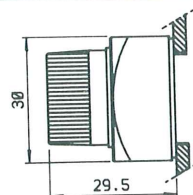

T2SHS

