

Features

- This switch is waterproof and is made out of ABS housing. Suitable for out-door use.
- Sleek appearance, ergonomic, patented design.
- Unique mechanical interlock design, which can help prevent short-circuit.
- Two stage speeds can be set according to wiring configuration. First stage: inching; Second stage: rapid movement.
- Can be used with emergency stop, pilot lamp, push button switch, selector switch, key switch. Versatile. Selector Switch Rated Current is 1th=10A.
- Single speed and double speed can be chosen alternatively.

Characteristics

Type	SPEC	External Diameter of Cable		Terminal	Remarks
THS94C	2A 500VAC 5A 250VAC	Two Holes	Ø11.4~Ø12.6	M4	Control Magnetic Switch
		Four Holes	Ø14.3~Ø15.5		
THS96C		Six Holes	Ø17.2~Ø18.4		

Model Description

	One-Two Holes	Three-Four Holes	Five-Six Holes	Seven-Eight Holes	Label
THS-9	4				None
THS-9	4	4			A
THS-9	6	6	6		
THS-9	EP	6	6	6	E

Designation	Signal	Description
Control Type	4	Indirect Double Speed (Mechanical Interlock)
	6	Indirect Single Speed
Push Button (ref page TA103)	EX	Emergency Stop+ Waterproof Rubber
	EB	Emergency Stop+ Flat Push Button Switch
	EI	Emergency Stop+ Illuminated Push Button Switch
	EK	Emergency Button+ Key Switch
	EP	Emergency Stop+ Pilot Lamp
	ES	Emergency Stop+ Selector Switch

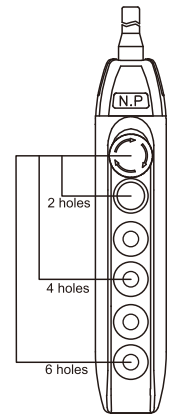

Note 1: "None" means Chinese label, A represents Arrow label, E represents English label see page TA121.

Note 2: Indirect Double Speed is represented by Double Arrow labels, without additional notation of the label code A.



THS-94 □

THS-944 □

THS-9466 □

THS-9EI466 □

■ Dimensions and Wiring Diagrams

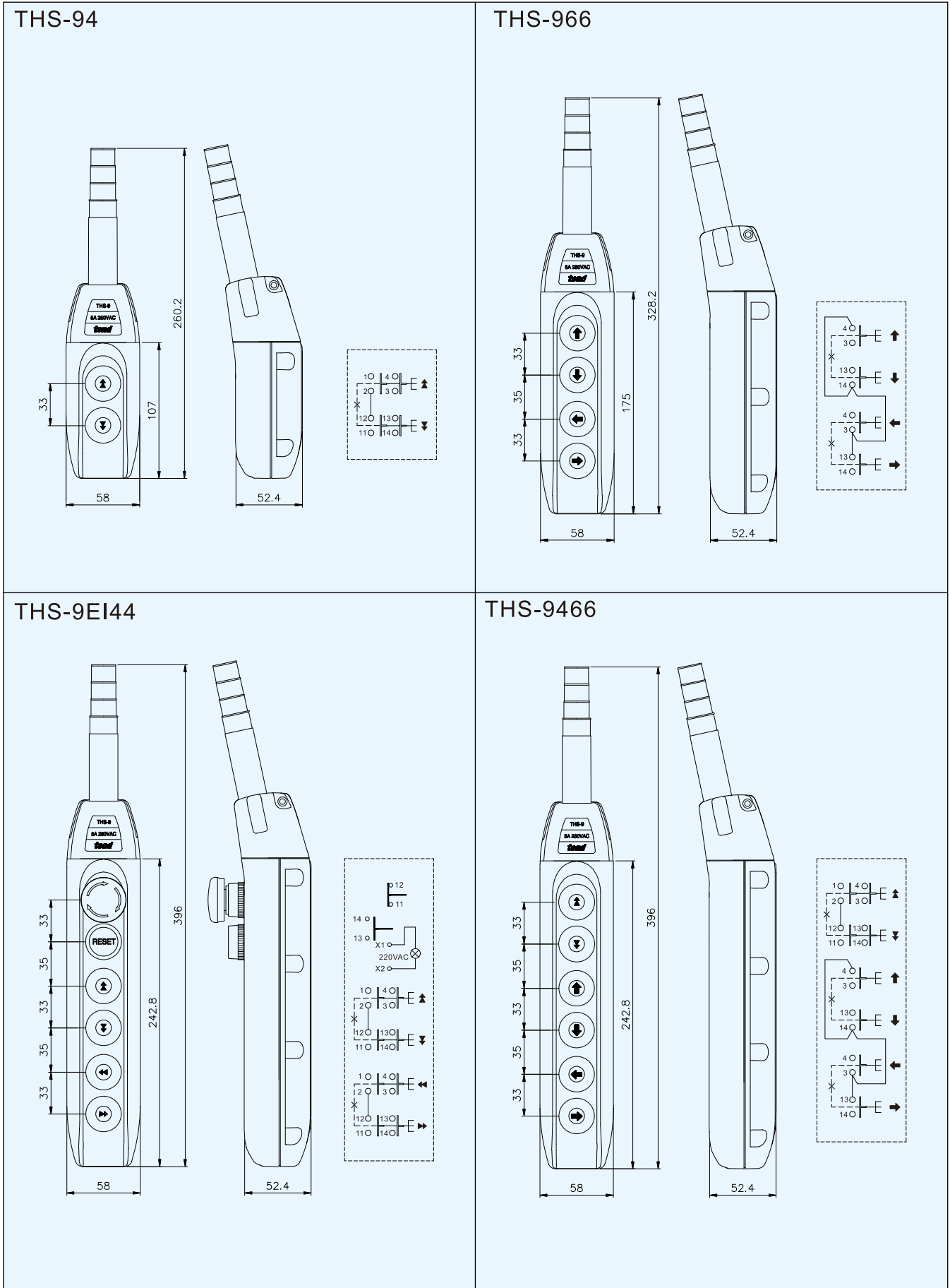

tend DIRECT HOIST PUSH BUTTON SWITCH(WATERPROOF TYPE) THS-8

FEATURES

- This switch can control three phases motor directly, No need to use magnetic switch Easy wiring.
- This switch is waterproof and made out of ABS housing. Suitable for out-door application.
- Unique mechanical interlock design, which can help prevent short-circuit.
- Can be used with emergency switch, pilot lamp, push button switch, or key switch. The rated current for the switch is Ith=10A.

CHARACTERISTICS

Type	SPEC	External Diameter of Cable		Terminal	Remarks
THS82C	Three 200/220VAC Phase 400/440VAC 2.2KW	Two Holes	Ø11.3~Ø13.5	M3.5	Control Motor Directly
		Four Holes	Ø13.3~Ø16.5		
		Six Holes	Ø16.3~Ø19.5		
		Eight Holes	Ø19.3~Ø22.5		

MODEL DESCRIPTION

	One-Two Holes	Three-Four Holes	Five-Six Holes	Seven-Eight Holes	Label
THS-8	2				None
THS-8	2	2			A
THS-8	ES	2	2		E
THS-8	EP	2	2	2	E

Designation	Signal	Description
Control Type	2	Direct Single Speed
Push button Switch (see page TA103)	EX	Emergency Stop+ Waterproof Rubber
	EB	Emergency Stop+ Flat Push Button Switch
	EI	Emergency Stop+illuminated Push Button Switch
	EK	Emergency Stop+ Key Switch
	EP	Emergency Stop+ Pilot Lamp
	ES	Emergency Stop+ Selector Switch
	PB	on-off(1A)Switch

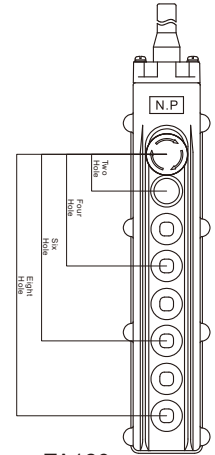

Note : None:Represents Chinese sticker, A:Represents the arrow sticker, E:Represents English sticker, see page TA123



■ DIMENSIONS AND WIRING DRAWING

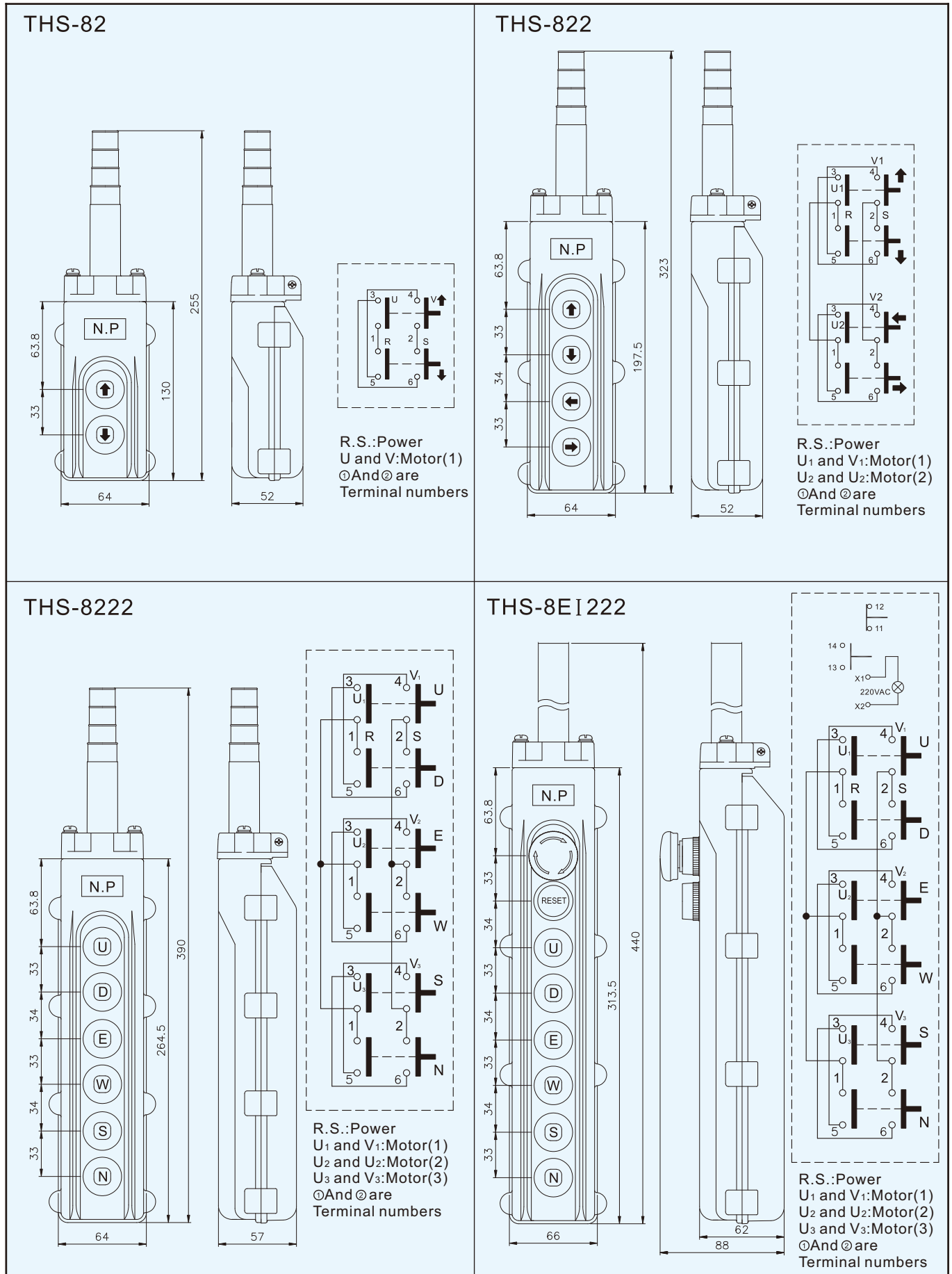

tend INDIRECT HOIST PUSH BUTTON SWITCH(WATERPROOF TYPE) THS-8

FEATURES

- This switch is IP67 waterproof and made out of ABS housing. Suitable for out-door use.
- Can be used with emergency stop, pilot lamp, push button switch, or key switch.
- Single speed and double speed can be chosen alternatively.

CHARACTERISTICS

Type	SPEC	External Diameter of Cable		Terminal	Remarks
THS83C	2A 500VAC	Two Holes	Ø11.4~Ø12.6	M4	Control magnetic switch
	5A 250VAC	Four Holes	Ø14.3~Ø15.5		
THS86C	2A 500VAC	Six Holes	Ø17.2~Ø18.4		
	5A 250VAC	Eight Holes	Ø15.7~Ø17.1		

MODEL DESCRIPTION

	One-Two Holes	Three-Four Holes	Five-Six Holes	Seven-Eight Holes	Label
THS-8	3				None
THS-8	3	3			A
THS-8	6	6	6		
THS-8	EP	6	6	6	E

Designation	Signal	Description
Control Type	3	Indirect double-speed (electrical interlock)
	4	Indirect double-speed (mechanical interlock)
	6	Indirect single-speed (electrical interlock)
Push button Switch (see page TA103)	EX	Emergency Stop+ Waterproof Rubber
	EB	Emergency Stop+ Flat Push Button Switch
	EI	Emergency Stop+illuminated Push Button Switch
	EK	Emergency Stop+ Key Switch
	EP	Emergency Stop+ Pilot Lamp
	ES	Emergency Stop+ Selector Switch
	PB	On-off(1A) Switch

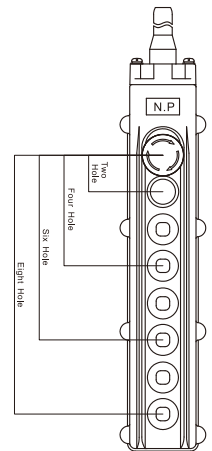

Note1: None: Represents Chinese sticker, A: Represents the arrow sticker, E: Represents English sticker, see page TA123



THS-83 □

THS-866 □

THS-8366 □

THS-8E|366 □

THS-8PB466 □

DIMENSIONS AND WIRING DRAWING

THS-83

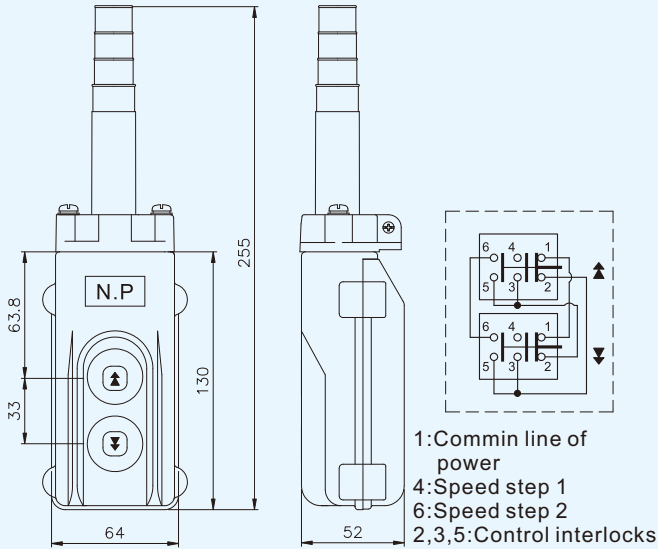

THS-866

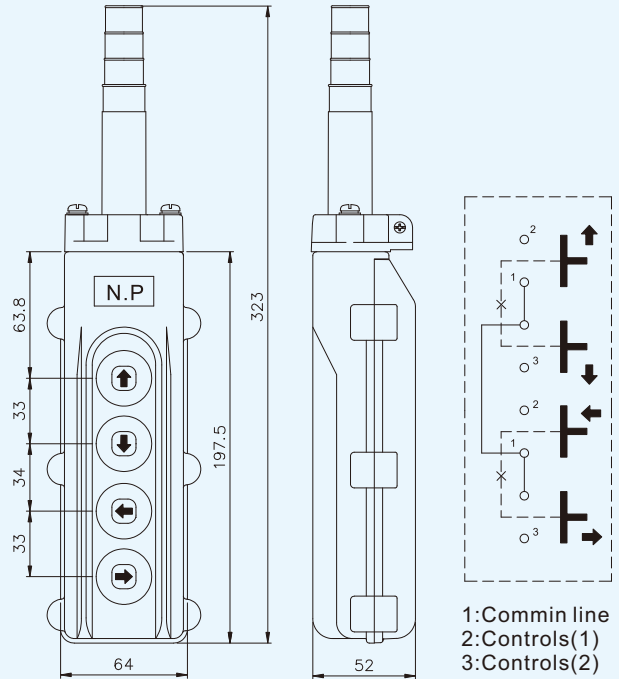

THS-8366

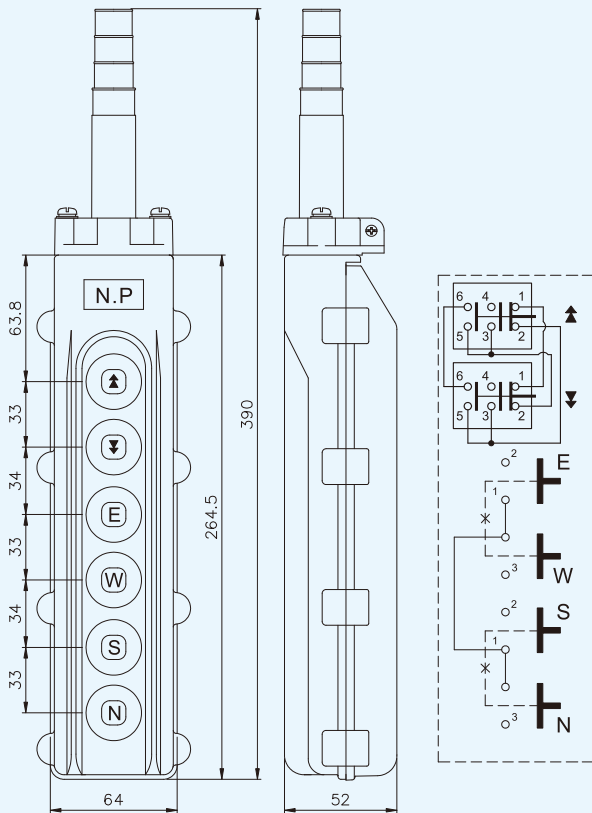

THS-8E|366

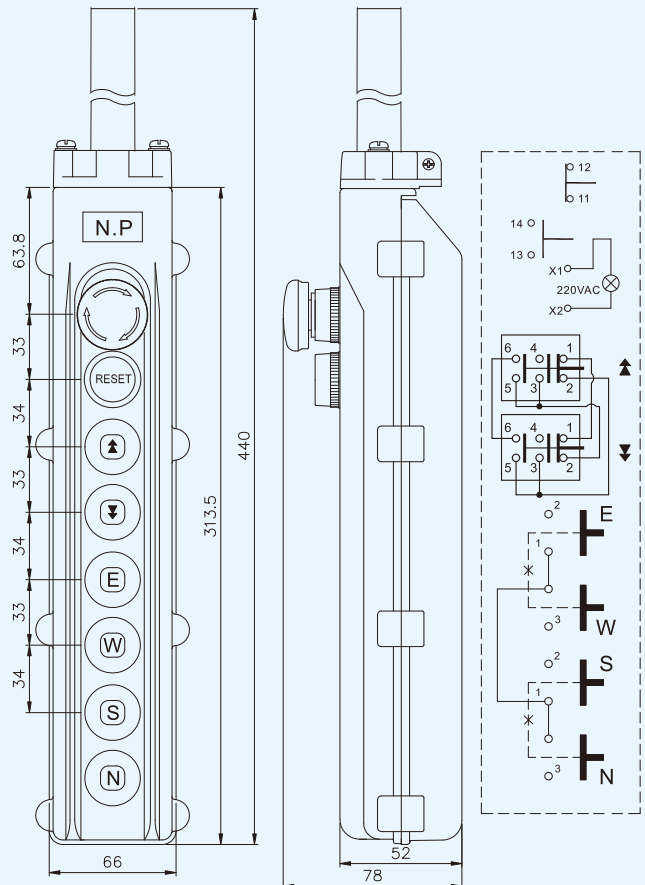

tend INDIRECT HOIST PUSH BUTTON SWITCH(WATERPROOF TYPE) THS-8

■ PUSHBUTTON SWITCH(SELECTABLE)

Type	Photograph	Wiring diagram	Type	Photograph	Wiring diagram
E (THS-BKR)		(1b) 	S (THS-SSR)		(2a)
B (THS-BFR)		(1a1b) 	PB (THS-PB)		(1a)
I THS-IFR		(1a) Lamp Voltage:220VAC 	X (THS-X)		2*TP4*8 Screw Blanking Plate
K (THS-KSR)		(2a) 	■ LABEL TYPES 2HS8C02 □ (The glue is applied on top side of the label and is designed only for THS8 series) Symbol Label(A) English Abbreviation Label(E) 		
P (THS-PR)		Lamp Voltage:220VAC 			

tend DIRECT HOIST PUSH BUTTON SWITCH THS-2

FEATURES

- This switch is made out of ABS housing. Suitable for out-door use.
- This switch can control three phases motor directly. No need to use magnetic switch Easy wiring.
- Unique mechanical interlock design, which can help prevent short-circuit.

CHARACTERISTICS

	Type	Label	Button	SPEC	External Diameter of Cable	Terminal	Remarks
Direct Operation	THS-213	None	2(1 Set)	Single Phase 100/110VAC 0.75KW 200/220VAC 1.5KW	Ø13.3~Ø16.5	M3.5	Control Motor Directly
	THS-213L						
	THS-21	A	2(1 Set)	Three Phases 200/220VAC 400/440VAC	Ø11.3~Ø13.5		
	THS-22				Ø13.3~Ø16.5		
	THS-23		E	6(3 Sets)	2.2KW		

Note : None:Represents Chinese sticker, A:Represents the arrow sticker, E:Represents English sticker, see page TA126



tend DIRECT HOIST PUSH BUTTON SWITCH THS-2

DIMENSIONS AND WIRING DRAWING

THS-21

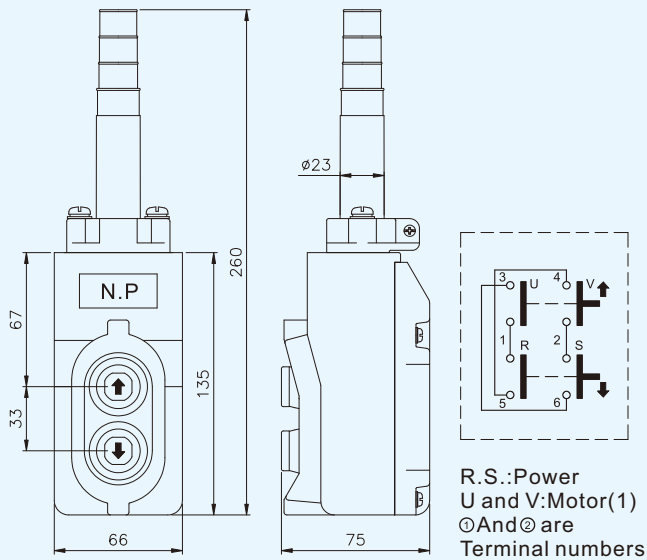

THS-213

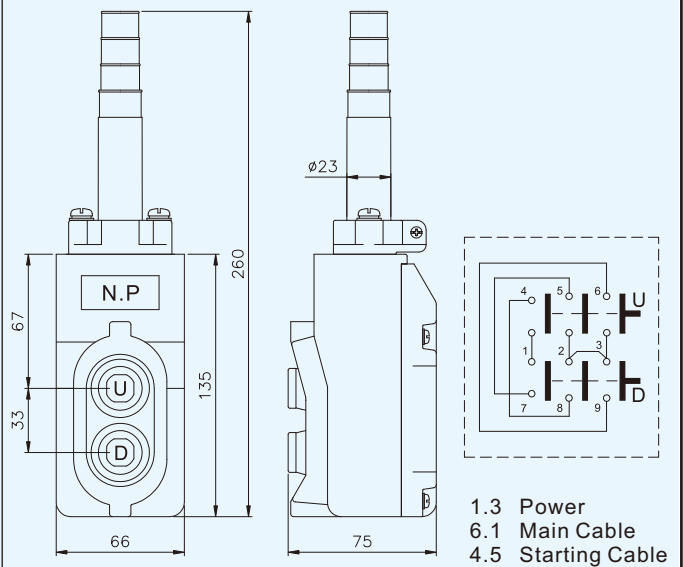

THS-22

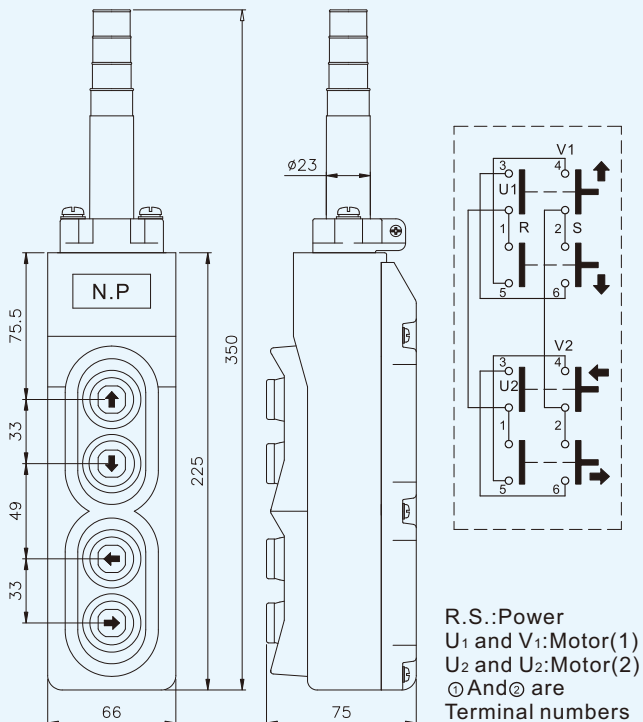

THS-23

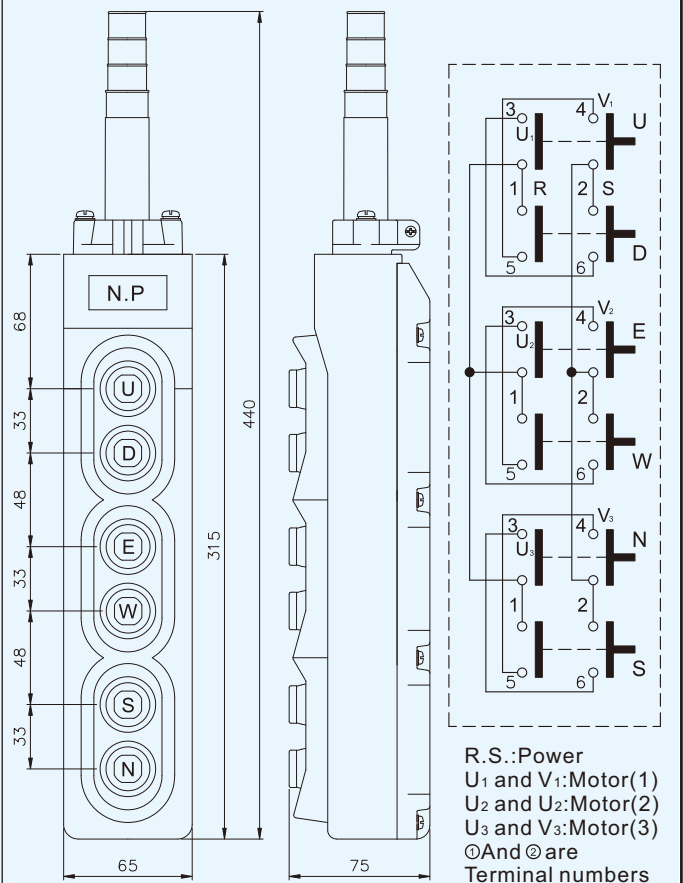

tend DIRECT HOIST PUSH BUTTON SWITCH THS-2

CHARACTERISTICS

Type	Label	Button	Push button combination	Description	Diameter of lead	Terminal	Remarks	
Direct Operation	THS-EP213	None	1	T2BKRR-1B Emergency stop 2B(red)	10A 250VAC	Ø13.3~Ø16.5	M3.5	Control Motor Directly
			2	T2PR2R Indicator(Red)	220VAC			
			3	THS-213C 213 Contact Block	100/110V 0.75KW			
			4		200/220V 1.5KW			
	THS-EI22	A	1	T2BKRR-1B Emergency stop 1B(red)	10A 250VAC			
			2	T21FR2G-1A illuminated flat head push button switch 1A(green)	220VAC			
			3	THS-2C-S 21Contact Block	200/220V 2.2KW			
	4	400/440V 2.2KW						
	THS-EI23	E	1	T2BKRR-1B Emergency stop 1B(red)	10A 250VAC			
2			T21FR2G-1A illuminated flat head push button switch 1A(green)	220VAC				
3 4 5 6			2*THS-2C-S 21 Contact Block*2	200/220V 2.2KW 3Ø 400/440V 2.2KW				

Note:None : represents Chinese sticker , A:represents the arrow sticker , E:represents English sticker , see page TA126

DIMENSIONS AND WIRING DRAWING



THS-EP213 □

THS-EI22 □

THS-EI23 □

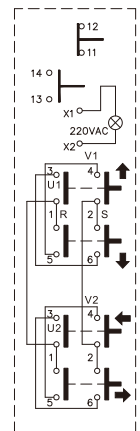
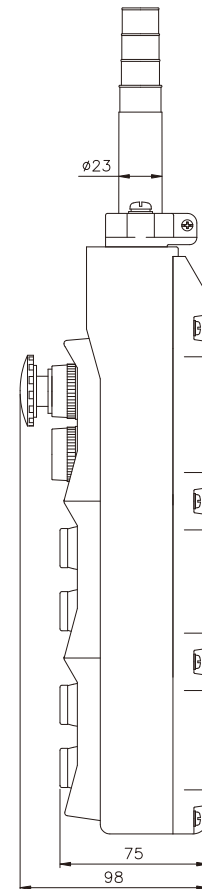
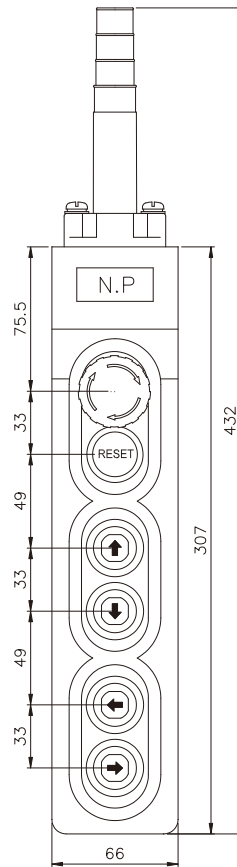

R. S. :Power
 U₁andV₁: Motor(1)
 U₂andV₂: Motor(2)
 ①And② are terminal numbers

tend INDIRECT HOIST PUSH BUTTON SWITCH THS-6

FEATURES

- 本開關為防水之懸吊式吊車開關，外殼採用ABS樹脂，絕緣佳，即使屋外使用，亦安全無虞。
- 本開關採機械連鎖配線，可防止馬達正逆短路現象。

CHARACTERISTICS

	Type	Label	Button	SPEC	External Diameter of Cable	Terminal	Remarks
間 接 操 作 用	THS-61	None	2(1 Set)	5A 250VAC 2A 500VAC	Ø11.4~Ø12.6	M4	Control magnetic switch
	THS-62	A	4(2 Sets)		Ø14.3~Ø15.5		
	THS-63	E	6(3 Sets)		Ø17.2~Ø18.4		

Note : None:Represents Chinese sticker, A:Represents the arrow sticker, E:Represents English sticker, see page TA126



THS-61 □

THS-62 □

THS-63 □

tend INDIRECT HOIST PUSH BUTTON SWITCH THS-6

DIMENSIONS AND WIRING DRAWING

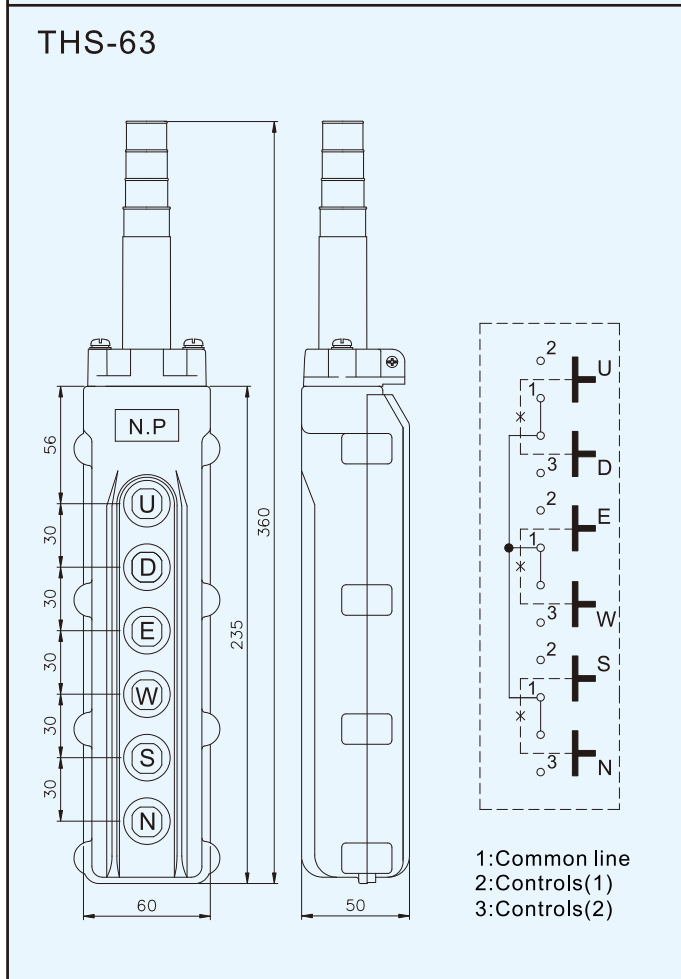
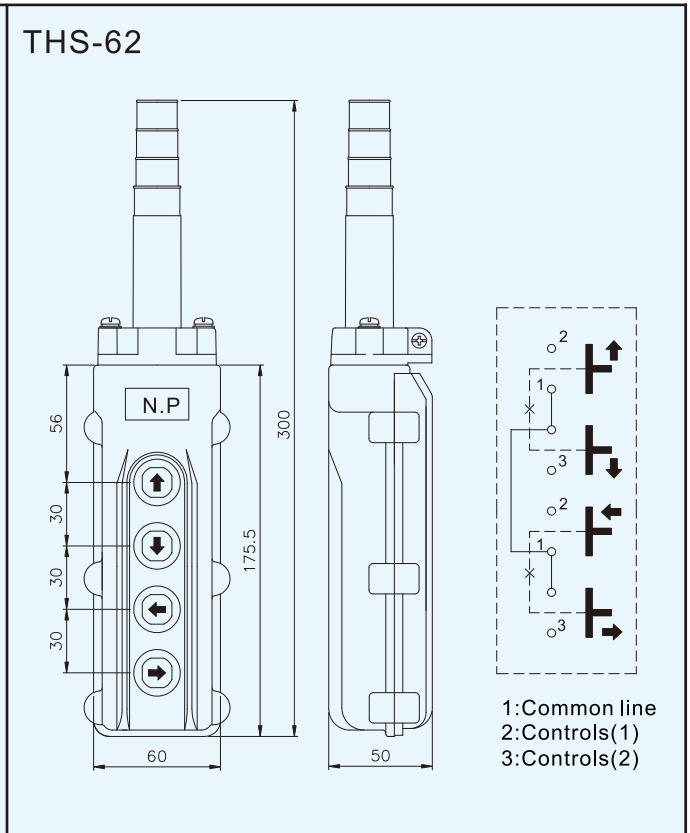
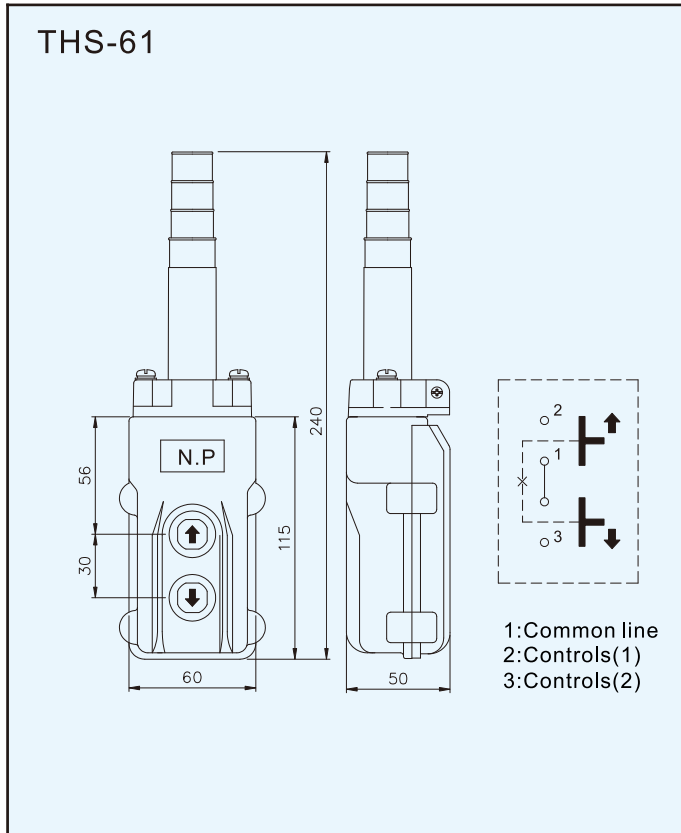

LABEL TYPES 2HS2C02 □

(The glue is applied on back side of the label and is designed only for THS2 and THS6 series)

Symbol Label(A)

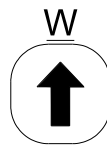

English Abbreviation Label(E)

